

insta-bed™

Air bed with built-in pump

Patent No. 5,827,052 Patent No. 6,332,760
Model #'s: 822501.1, 822502.1, 822503.1

CARE AND MAINTENANCE:

For better protection of this product, never unfold or inflate the airbed in temperatures below freezing, avoid extensive exposure to the sun and protect from contact with sharp objects and rough ground. Make sure to handle the pump with care. Clean air beds only with mild soap and water. Pump gasket may need occasional lubrication to maintain a positive seal. Storage at high temperatures may reduce battery life.

NOTE:

Air bed material may stretch during first use and may need additional air to reach desired firmness. Air inside of bed may expand and contract with varying temperatures potentially leading to reduced pressure inside of bed.

REPAIRING:(Repair Patch Included)

For small puncture holes, tears or cuts, cut a small piece of PVC patch material (included) and apply patch. Allow at least four (4) hours for repair to set before attempting to inflate the air bed.

CAUTION:

1. Do not over inflate.
2. For proper pump usage, it is recommended not to exceed 10 minutes of inflation/deflation time.
3. Make sure to return the pump to its original position to prevent damage to the pump during storage.
4. Do not use as a water float or as a life saving device.
5. Never allow sand, small rocks or any objects to be sucked into the pump while operating.
6. It is recommended to separate the batteries from the battery case when the pump is not in use.
7. Do not mix old and new batteries. Do not mix alkaline, standard (carbon-zinc), or rechargeable (nickel cadmium) batteries.

INFLATION

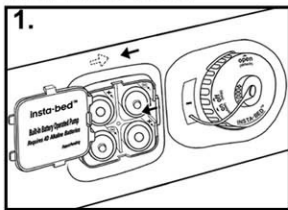

Remove the battery cover, insert four new D-size alkaline batteries. (not included) Make sure the batteries are inserted correctly and battery cover closed with a click.

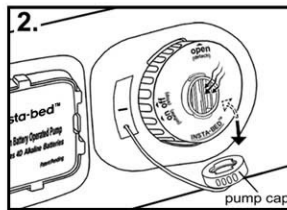

To inflate air mattress, unscrew pump cap to turn switch to "On" position. When air mattress reaches desired firmness, turn switch to "Off" position. Replace pump cap tightly and the air bed is ready to use.

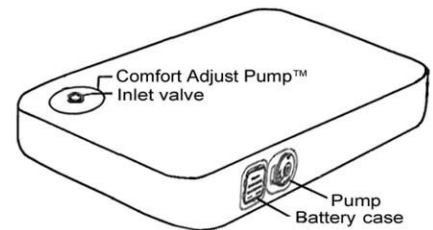

To Increase Firmness Using Comfort Adjust Pump™

Note: There is no cap to remove during this process.

Do not get sand or dirt near this pump it will affect the performance.

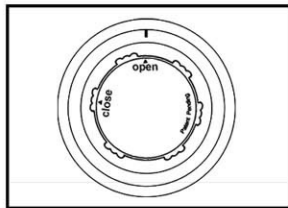

Turn Comfort Adjust Pump™ counter-clockwise to align with "Open" for inflation.

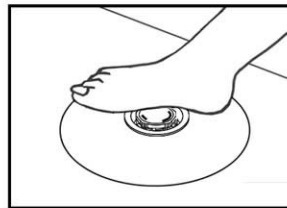

Continuously press up and down on the Comfort Adjust Pump™ by hand or foot until the desired firmness is reached.

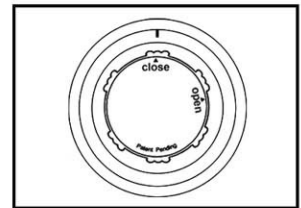

Turn Comfort Adjust Pump™ clockwise to align with "Close" after inflation.

DEFLATION

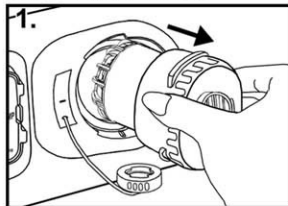

Unscrew pump cap and turn pump to "Open" position and detach pump. For faster deflation, it is recommended to first detach pump and leave the bed to deflate naturally for one minute.

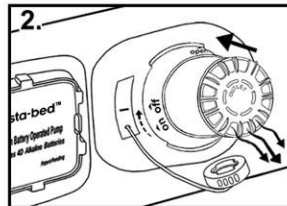

Reverse the pump by inserting the inlet side of the pump into valve. Switch to "On" position to deflate.

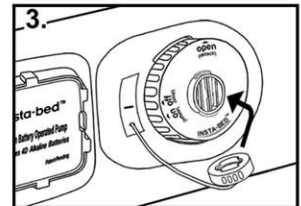

When finished deflating turn switch to "Open" position and remove pump. Then reverse pump by returning it to its original position. Switch to "Off" position and replace pump cap before storing.